

SPRINGBROOK CONDOMINIUM ASSOCIATION
2000 Springbrook Circle
Portsmouth, NH 03801
603.610.0165
www.springbrookcondos.com

September 4, 2012

RE: Dogs

Springbrook resident:

This letter is for every Springbrook resident—those who own dogs and those who do not.

While dogs are allowed at Springbrook, the volunteer Board of Directors and our Property Manager, Ron Maglieri, are charged with setting and enforcing reasonable guidelines to ensure the safety and convenience of all residents and maintain the cleanliness of the property.

Along these lines, the Board is requiring residents to register their dog(s) with the Association. (There is no charge for this registration.)

On the back of this sheet is the official Springbrook dog map, indicating the designated dog-walking areas. ***On the separate (attached) sheet, every resident must fill out the dog registration form. If you do not have a dog, you simply check that box and drop the sheet in the 2000 mailbox. All forms must be returned by September 17, 2012.***

Our Residency Rules and Regulations (available at our website under Policies) highlight several basic requirements dog owners must follow:

- Pets shall be maintained in a manner that does not create an annoyance or nuisance to other unit owners or residents (i.e., continuous barking).
- Dogs shall be kept on a leash and under control when outside the unit. When pets are taken outdoors to relieve themselves, they must be walked off the common grass and landscaped areas and away from the pond into the woods on the periphery of the property. (See dog map.)
- Pet owners are responsible for immediately removing any excrement deposited outside the peripheral woods, using a pooper-scooper or similar means, and putting the waste into the proper dumpster.

If you have any questions, please let us know. Thank you very much. Regards,

Springbrook Board of Directors
cc: Ron Maglieri, Property Manager

DRAFT

TRUE NORTH

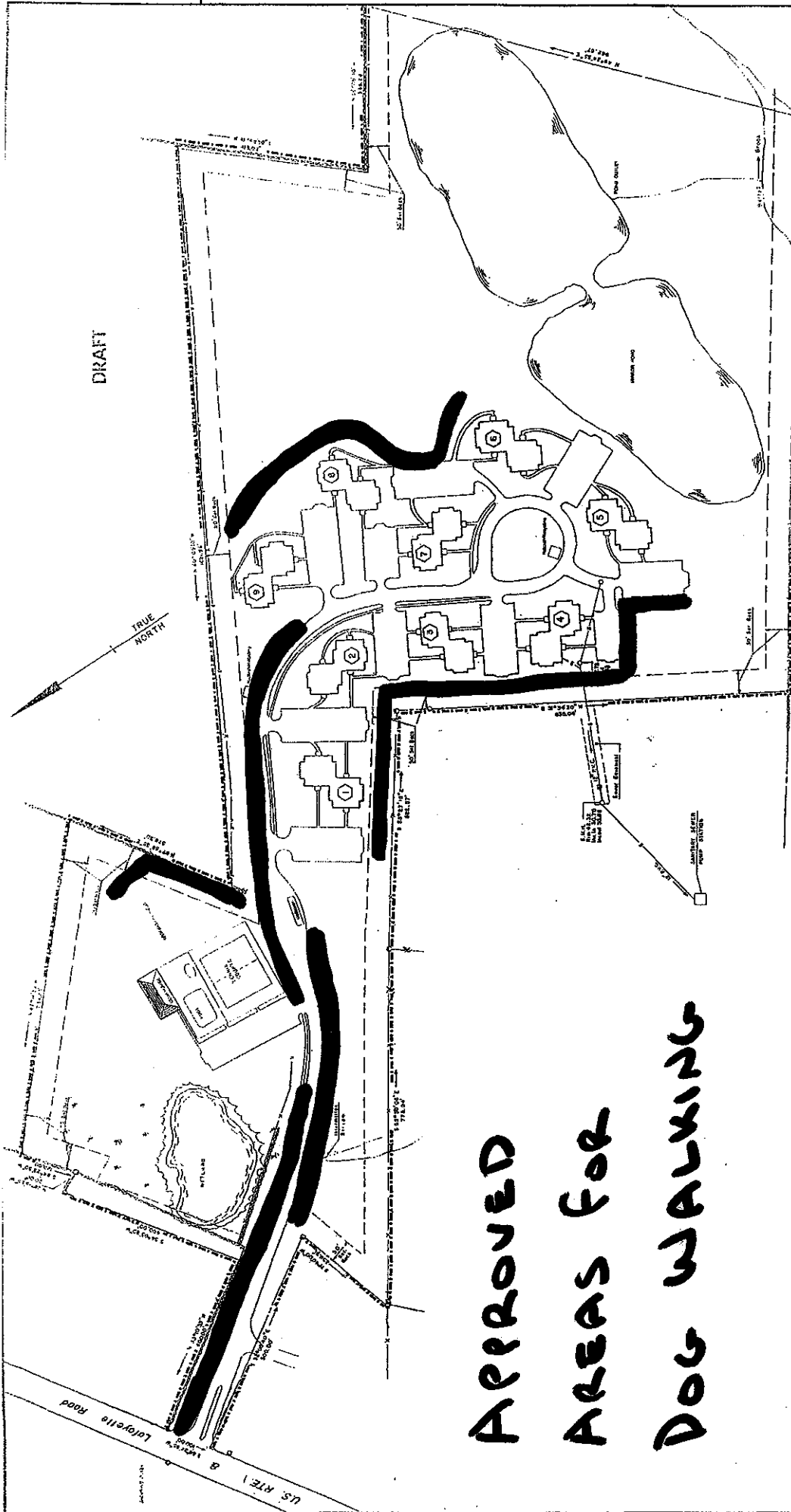

**APPROVED
AREAS FOR
DOG WALKING**

REDUCED DRAWING SIZE
Scale: 1" = 200' (approximately)

NOTES

1. This plan was prepared from the original drawings. All the building footprints and parking areas are shown in this plan. The building footprints are shown in solid lines and the parking areas are shown in dashed lines. The dog walking areas are shown in thick black lines.
2. This site plan was prepared in accordance with the requirements of the City of Springfield, Massachusetts, and the State of Massachusetts. It is intended to be used for informational purposes only and does not constitute a contract or any other legal document. The user of this plan should consult with the appropriate authorities for all applicable laws and regulations.

Site Plan of Springbrook Condominiums

Location:	U.S. Route 1 Lafayette Road, Springfield, MA
Building:	2000 Springfield Circle
Address:	Springfield, MA 01107
Scale:	1" = 200' (approximately)
Date:	March 22, 2001
Drawn by:	[Name]

Springbrook Dog Registration Form

This form must be filled out by all residents of Springbrook (the owner or renter—whoever lives in the unit). Please provide your unit number, your name(s), and check either of the boxes (dog bones) below.

Please drop this form in the 2000 mailbox (inside the back of the mailhouse) no later than Monday, September 17, 2012. Thank you.

Unit number: _____

Owner/renter name(s): _____

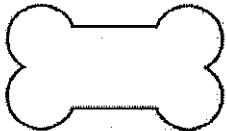

**I do own a dog/dogs
(please provide the following information)**

Dog #1

Dog #2

Dog #3

Dog type/breed: _____

Color: _____

Weight (approx): _____

City license #: _____



I do NOT own a dog/dogs